

REVISION DESCRIPTION		APP.	DRW.	DATE	CHANGE NO.
△ x 1	HSG design change	K. Abe	O. Shimizu	13/10/22	
△ x					
△ x					

50	24.5	32.4	27.1	31.05	CNU018S-050-0012
32	15.5	23.4	18.1	22.05	CNU018S-032-0012
24	11.5	19.4	14.1	18.05	CNU018S-024-0012
Pin count	Lp	L1	L2	L3	P/N

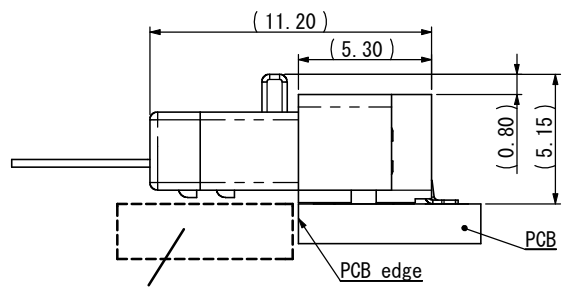
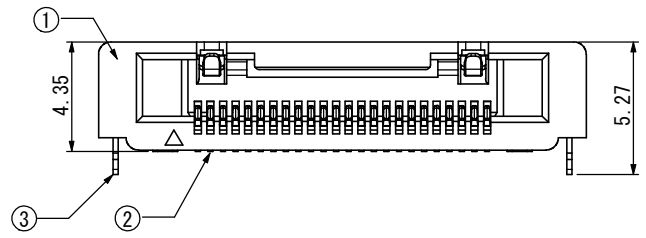
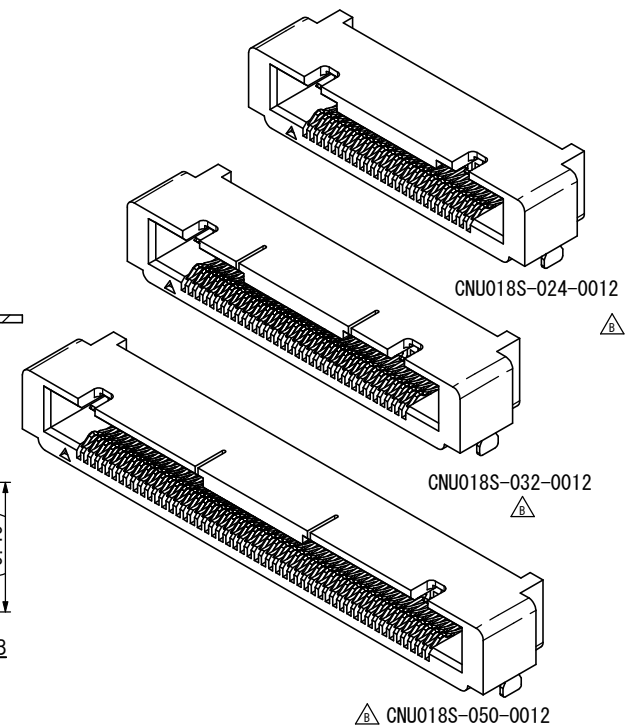
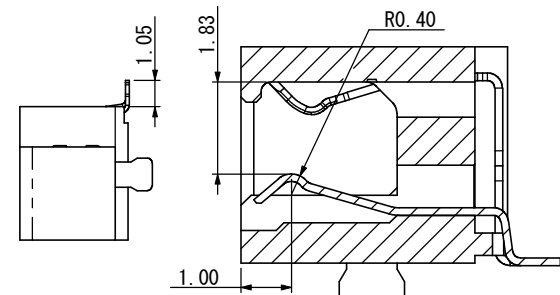
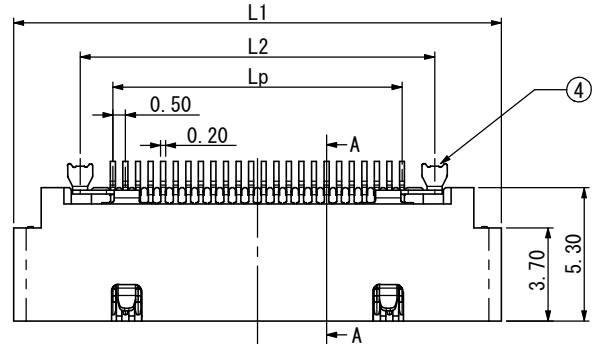

No component area recommended  
CNU018P-xxx-0001 mating condition

- Note.
- Coplanarity between terminal and reinforcement bracket terminal should be 0.10mm max.
  - Performance shall be referred to YEU-F2012.
  - Applicable plug CNU018P-xxx-0001

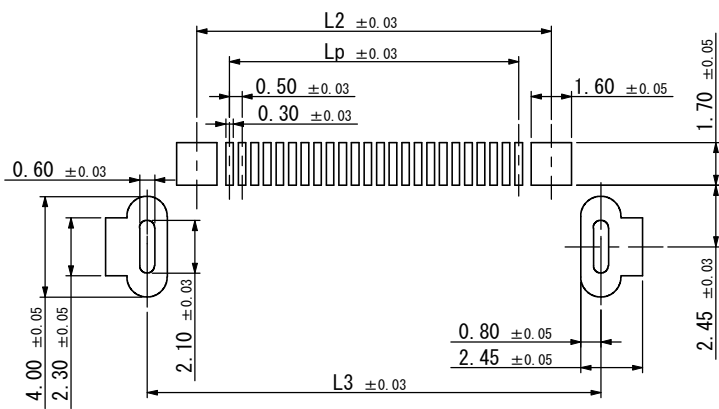

Item No.	Description	QNT.	Material	Content
4	Reinforcement bracket-2	2	SUS	Ni/Au
3	Reinforcement bracket-1	2	SUS	Ni/Au
2	Contact	n	Copper alloy	Ni/Au
1	Insulator	1	LCP	Black

Tolerance ±0.25 Unless otherwise specified.							
						CLASS	
SCALE	5/1	APP.	APP.	CHK.	DRW.	DSGN.	TITLE
DIMENTION	mm	13/05/09	13/05/09	13/05/09	13/05/09	13/05/09	CNU018S-xxx-0012
ANGLE PROJ	3rd	K. Abe	K. Abe	O. Shimizu	O. Shimizu		DRW No. YEU-A2199
						Sheet No.	REV.
						/	B